



Spare parts catalogue

Winch
NP 05 L.F6

DINAMIC OIL S.p.A.

Via Togliatti, 15
41030 Bomporto (MO)
tel +39.059.812611
fax +39.059.812603
dinamicoil@dinamicoil.it

Spare parts catalogue No.

L465

Logbook code

WNP005S0CA20

Edition

04/06/2015

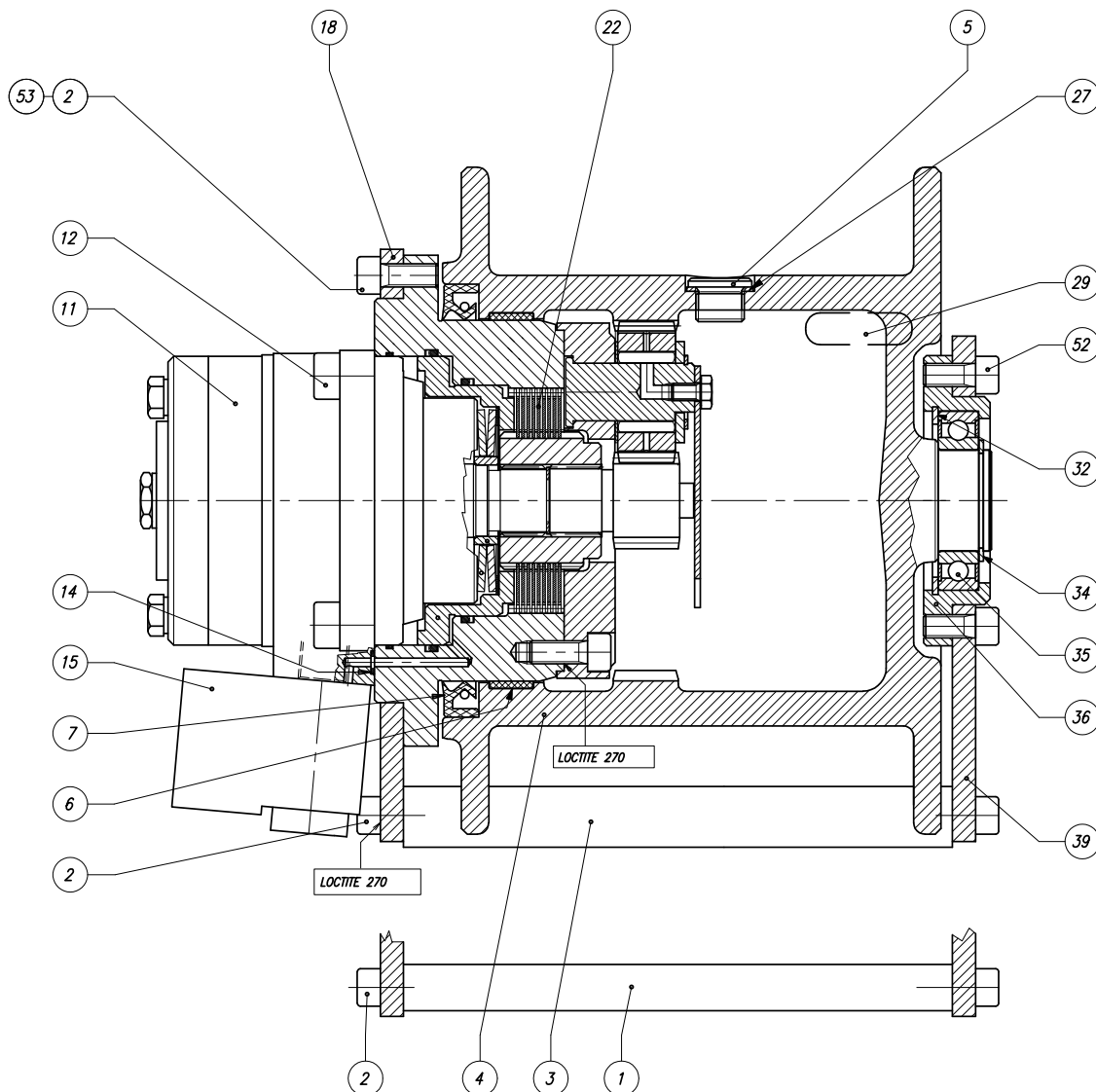
Revision

0

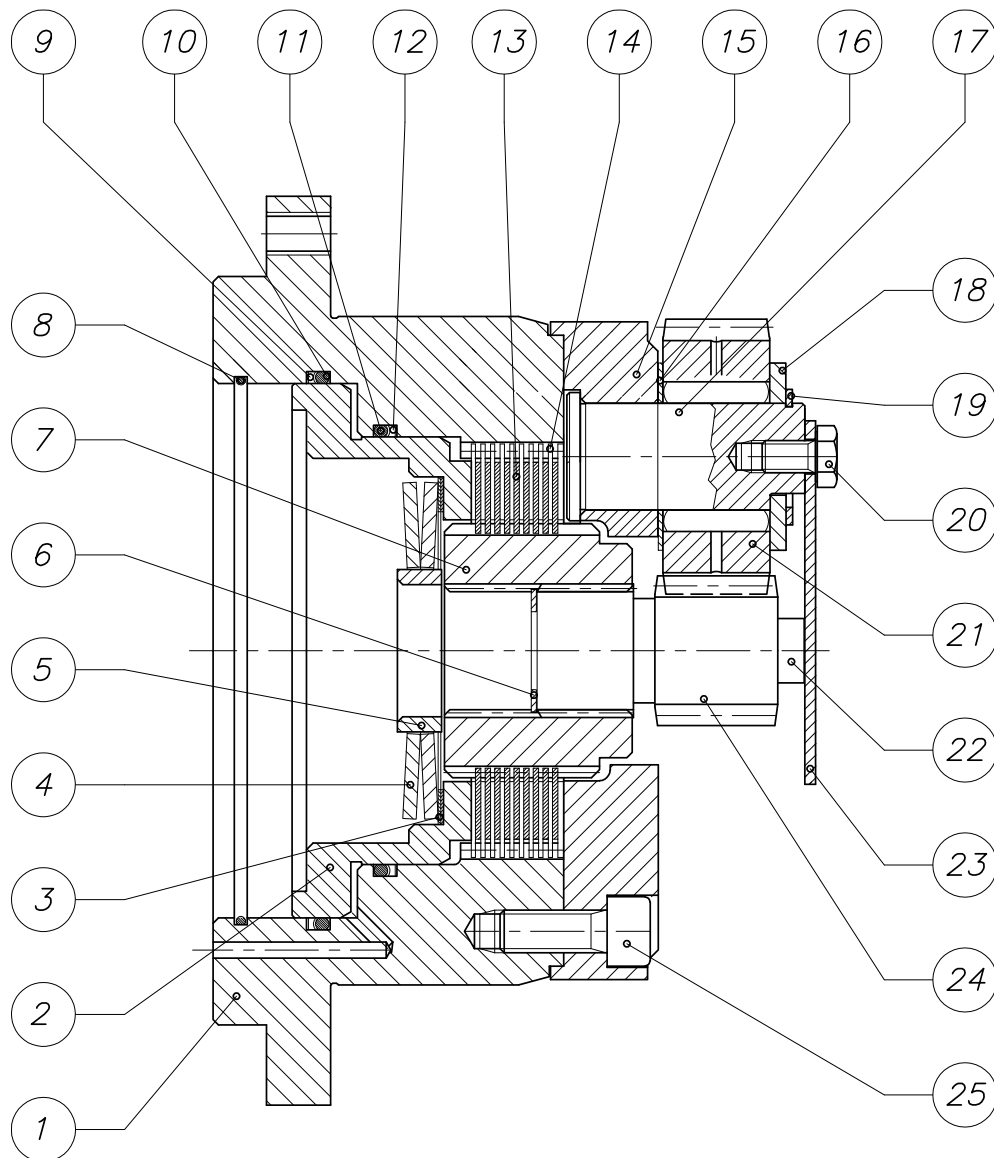


Table index	<i>Winch</i>	NP 05 L.F6
	<i>Logbook code</i>	WNP005S0CA20

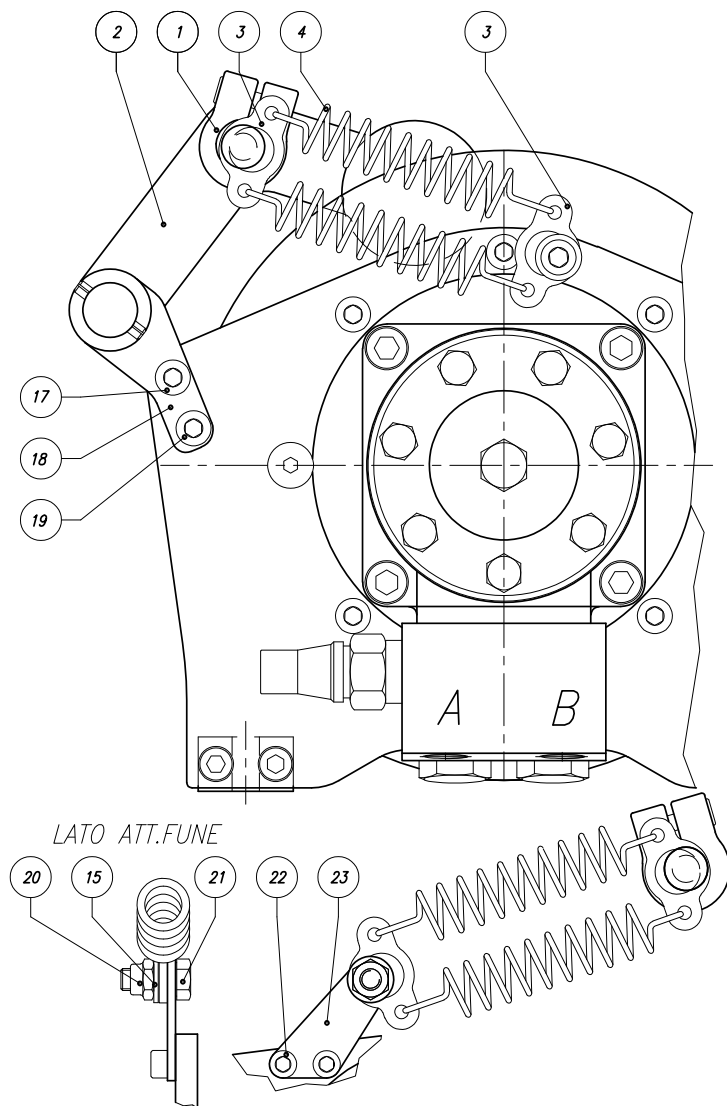
Page	Table code	Table heading
3	WNP005S0CA20	WINCH NP 05 CCW SMOOTH Ø6 CABLEPRESS
4	029810117	BRAKE GROUP NP05-12
5	905092000-1	CABLE TENSIONER KIT NP05-NP12
6	905092000-2	CABLE TENSIONER KIT NP05-NP12



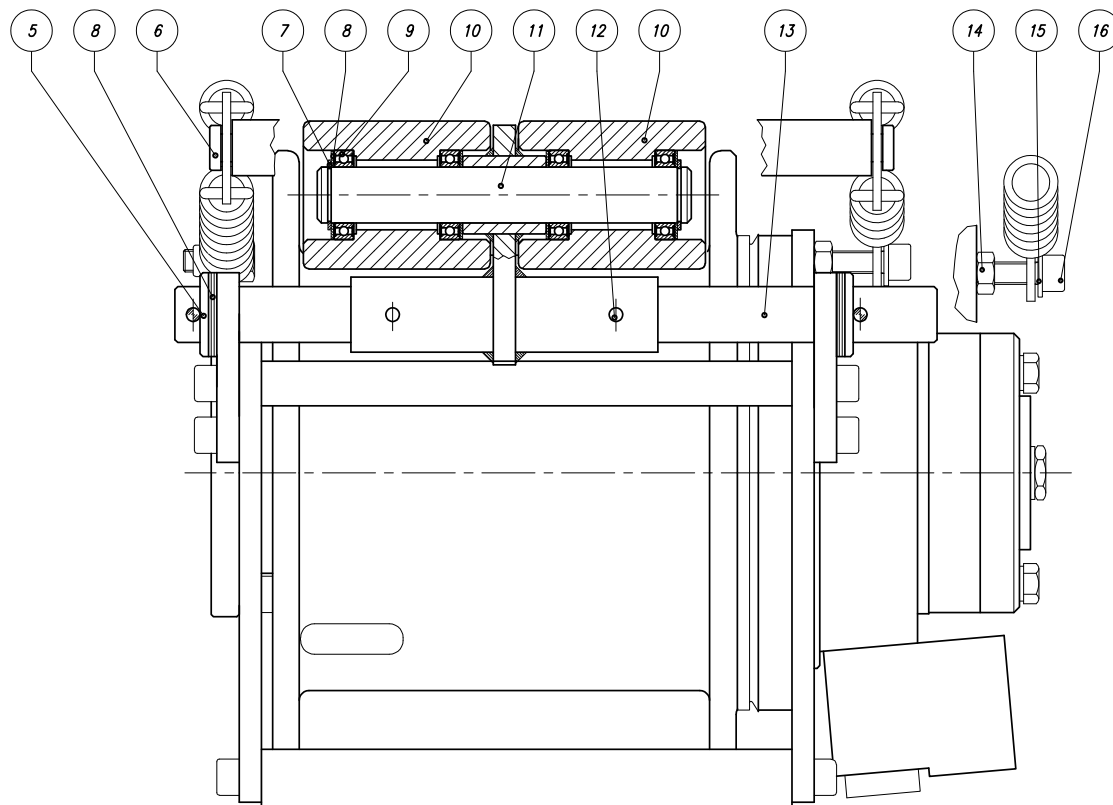
Pos	Code	Qty	Description
1	273103700	2	SPACER SUPPORT NP10
2	410402900	22	HEX SOCKET HEAD CAP SCREW M8X20 12.9
3	273103600	2	FIXING PLATE NP10
4	02301026	1	DRUM
5	419000700	1	PLUG TCEI 3/8" GAS DIN908
6	294201800	1	GUIDE RING ATS-F 125X130X14,8 RFG
7	415011300	1	OIL SEAL 125X150X12 BASL
11	029410135	1	MOTOR DANFOSS OMR550 SHAFT B25X22 NOT FASE DX
12	410407000	4	SCREW TCEI M10X25 12.9 UNI 5931
14	406001100	1	O-RING 2-008
15	438010600	1	VALVE VBO-48-FMOSSE
18	234001400	1	MOTOR SIDE SUPPORT NP10
22	029810117	1	BRAKE GROUP NP05-12
27	423000600	1	SOFT COPPER WASHER 3/8" UNI 6953
29	02410214	1	WEDGE NP05 Ø6 P9 Ø7-8
32	421101000	1	HOLE SEEGER Ø62
34	421000500	1	SHAFT SEEGER Ø35
35	400003800	1	BALL BEARING 6007 2RS TYPE B
36	235100100	1	SUPPORT BEARING RING NP10
39	234001300	1	SUPPORT SIDE ROPE CONNECTION NP10
52	410412200	4	HEX SOCKET HEAD CAP SCREW M8X18 12.9
53	410040400	2	HEX SOCKET COUNTERSUNK HEAD CAP SCREW M8X20 10.9



Pos	Code	Qty	Description
1	233102400	1	CARRIER FLANGE WINCH NP10
2	02271003	1	BRAKE PISTON MD
3	427014300	2	THICKNESS SHIM ADJUSTMENT 52X65X0,5 DIN988
4	416202600	2	BELLEVILLE SPRING 63X31X2,5
5	2030090700	1	SPRING GUIDE RING GR100-200 FN DIS
6	421103200	1	CLIP RING DIA 22
7	2020120400	1	HOLDER DISC GEAR FD
8	406000800	1	ORING 2-045
9	406015900	1	O-RING 2-155 N 741-75 (PARKER)
10	415069000	1	ANTIEXTRUSION FLUORTEN T-2684 (8-155)
11	406012000	1	O-RING 2-152 N 741-75 (PARKER)
12	415068900	1	ANTIEXTRUSION FLUORTEN T-2683
13	294182100	9	BRONZE DISC FD (1 MM)
14	294181900	10	STEEL DISC FD(0,8 MM)
15	237115100	1	PLANETARY CARRIER NP10
16	402002700	3	RALLA AS 20X35X0,8
17	260101200	3	PLANETARY CARRIER PIN NP10
18	402004000	3	FIFTH WHEEL CPS 1506 (3-17-35)
19	421000100	3	SHAFT SEEGER Ø20
20	410211000	3	HEX HEAD CAP SCREW M6X10 8.8 UNI 5739
21	02981902	3	PLANETARY GEAR GROUP NP10
22	2030101700	1	SOLAR GEAR PAD NP18
23	240100700	1	CONTAINMENT PLAQUE NP10-NP18
24	261101200	1	SOLAR GEAR NP10-NP12
25	410402900	9	HEX SOCKET HEAD CAP SCREW M8X20 12.9



Pos	Code	Qty	Description
1	029813102	2	NYLON CLAMP GROUP Ø20
2	029917169	1	CABLE PRESS ARM TYPE 01 INOX
3	02490285	4	SPRING PLATE I=8
4	418201900	4	TRACTION SPRING DIM T42590 INOX
15	423109700	2	FLAT WASHER Ø8.4X17X1.6 INOX
17	410416500	2	HEX SOCKET HEAD CAP SCREW M8X25 12.9 GEOMET 500B
18	024902100	2	CABLE PRESS SUPPORT PLATE INOX NP05-12
19	410150100	2	HEX SOCKET HEAD CAP SCREW M8X16 INOX A2-70
20	413102400	1	SELF-LOCKING NUT M8 LOW UNI7474 INOX
21	410023900	1	HEX HEAD CAP SCREW M8X20 INOX A2-70
22	410007700	2	HEX SOCKET HEAD CAP SCREW M6X10 INOX
23	024902101	1	HUB SIDE FLANGE SPRING COUPLING PLAQUE NP 05



Pos	Code	Qty	Description
5	423203800	2	WASHER Ø21 UNI6592 INOX SHIM 3
6	02601646	1	SPRINGS PIN Ø20X245
7	421005700	2	CLIP RING DIA 20 MM INOX
8	423010500	10	NYLON WASHER Ø20.2X31.5X1
9	400026700	4	BALL BEARING 61804 2RS
10	01010574	2	CABLE PRESS ROLLER Ø53X67 ERTALON 6 PLA
11	02601645	1	ROLL PIN Ø20X134
12	434010900	4	ELASTIC PIN Ø 5X30 UNI6873 INOX
13	02601647	1	PIN PRES.UNIFIC. INOX NP05-12
14	413002900	1	NUT M8 UNI 5588 INOX A2-70
15	423109700	2	FLAT WASHER Ø8.4X17X1.6 INOX
16	410083800	1	HEX SOCKET HEAD CAP SCREW M8X30 INOX UNI 5931