



Technical data

E

- Interchange:
- Occlusion: flat face
- Locking: lever with safety devices
- Material: steel and aluminum
- Finishing: Zn-Fe (Cr III), Zn-Ni, cataphoresis.
- Threads: BSP - NPT - SAE - METRIC
- Standard seals: NBR and PU
- Working temperature: -25 °C +100 °C
- Optional seals: FKM, EPDM or more.
- Working pressure: 350 bar
- Connection under residual pressure: allowed (male side only)

Technische Merkmale

D

- Norm:
- Verschluss: flachdichtend
- Kupplung: Hebel mit doppelter Sicherung
- Werkstoff: Stahl und Aluminium
- Ausführung: Zn-Fe (Cr III), Zn-Ni, Kataphorese.
- Gewinde: BSP – NPT – SAE – METRISCHE
- Standard-Dichtungen: NBR und PU
- Betriebstemperatur: -25 °C +100 °C
- Dichtungen nach Wahl: FKM, EPDM, usw.
- Betriebsdruck: 350 bar
- Kuppeln unter Restdruck: erlaubt (nur männliche Seite)

Nominal size				Max working pressure MPa	Rated flow l/min	Max flow rate l/min	Min burst pressure			Fluid spillage cc
DNP	BG	ISO	Ømm				Male MPa	Female MPa	Coupled MPa	
22	4A	16	12.8	35	74	150	140	140	140	0.012
25	4	19	14.8	35	100	200	140	140	140	0.015

1 MPa = 145.04 psi • 1 l = 0.264 gal

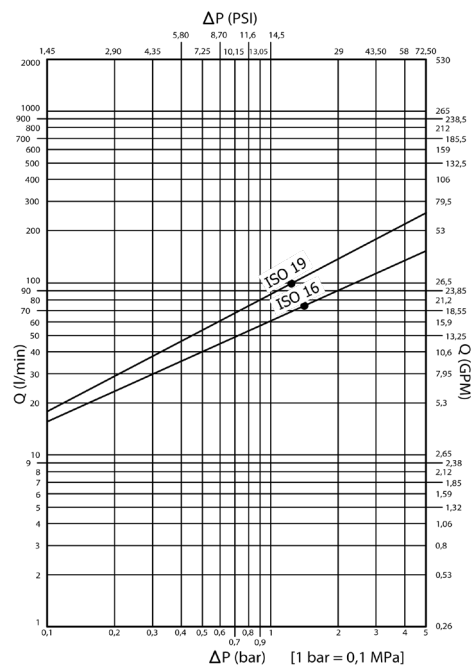

PSL2 DIMENSION

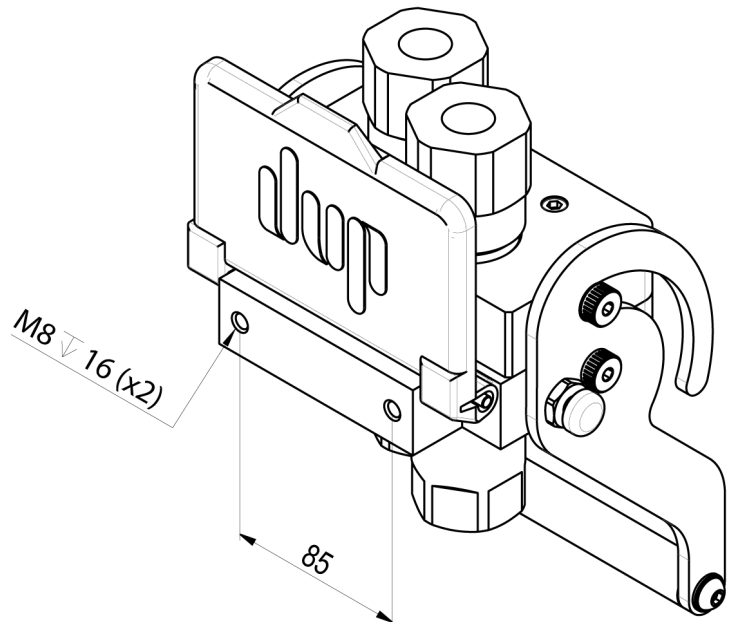
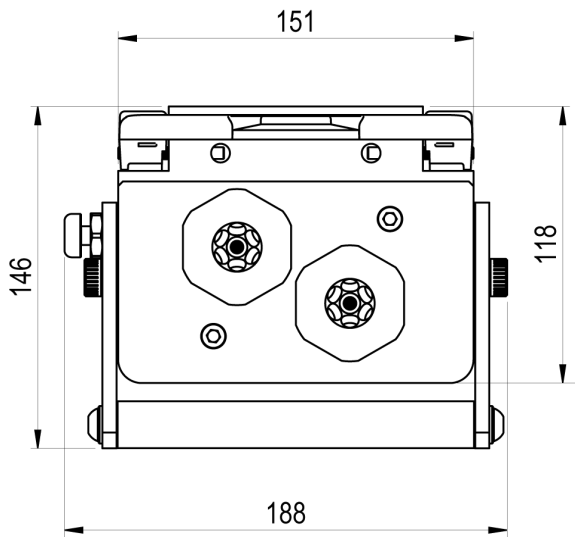
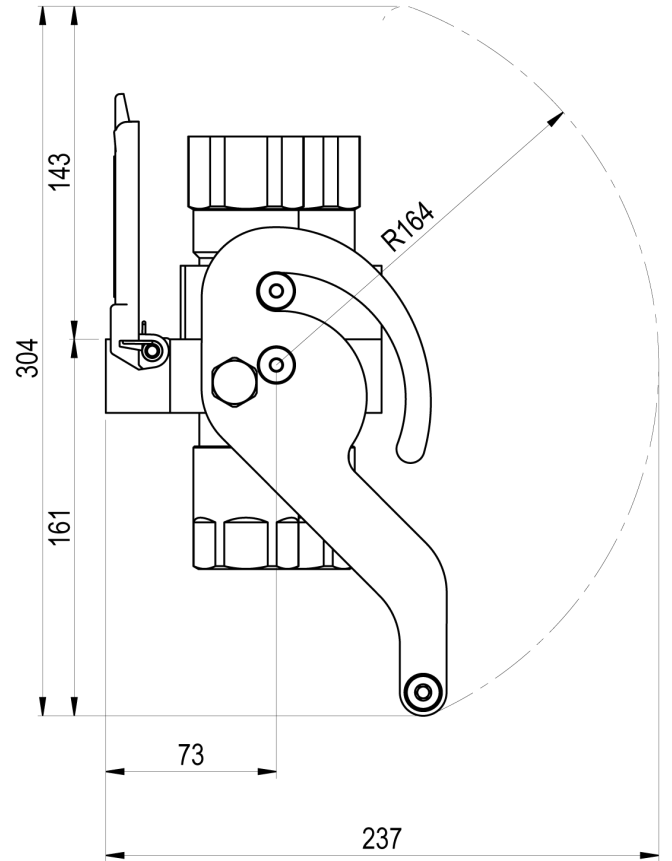
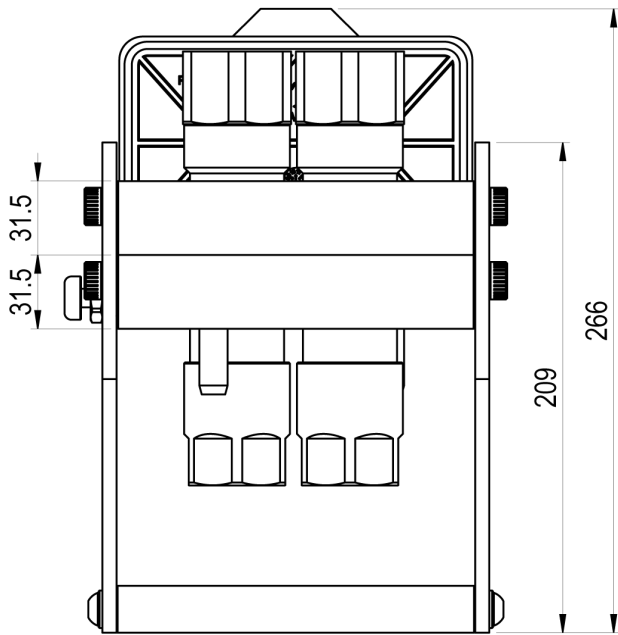

PSL2 FIXED



THREADS	DNP	BG	ISO	Housing	No. Couplings	Thread	STANDARD	FIXED PART CODE	
								CODE	Weight (g)
IG 1	22	4A	16	2	2	BSP 1/2"	DIN 3852-2-X	PSL2.2DCG.2	
	22	4A	16	2	2	NPT 1/2"	ANSI B1.20.3	PSL2.2DCN.2	
	22	4A	16	2	2	BSP 3/4"	DIN 3852-2-X	PSL2.2DDG.2	
	25	4	19	2	2	BSP 3/4"	DIN 3852-2-X	PSL2.2EDG.2	
	22	4A	16	2	2	NPT 3/4"	ANSI B1.20.3	PSL2.2DDN.2	
	25	4	19	2	2	NPT 3/4"	ANSI B1.20.3	PSL2.2EDN.2	
	25	4	19	2	2	BSP 1"	DIN 3852-2-X	PSL2.2EEG.2	
	25	4	19	2	2	NPT 1"	ANSI B1.20.3	PSL2.2EEN.2	
IG 2	22	4A	16	2	2	3/4"-16 UNF 2B	SAE J 1926-1	PSL2.2DCU.2	
	22	4A	16	2	2	7/8"-14 UNF 2B	SAE J 1926-1	PSL2.2DGU.2	
	25	4	19	2	2	1"-1/16-12 UN 2B	SAE J 1926-1	PSL2.2EDU.2	
	25	4	19	2	2	1"-5/16-12 UN 2B	SAE J 1926-1	PSL2.2EEU.2	

PSL2 MOBILE



THREADS	DNP	BG	ISO	Housing	No. Couplings	Thread	STANDARD	FIXED PART CODE	
								CODE	Weight (g)
IG 1	22	4A	16	2	2	BSP 1/2"	DIN 3852-2-X	PSL2.2DCG.3	
	22	4A	16	2	2	NPT 1/2"	ANSI B1.20.3	PSL2.2DCN.3	
	22	4A	16	2	2	BSP 3/4"	DIN 3852-2-X	PSL2.2DDG.3	
	25	4	19	2	2	BSP 3/4"	DIN 3852-2-X	PSL2.2EDG.3	
	22	4A	16	2	2	NPT 3/4"	ANSI B1.20.3	PSL2.2DDN.3	
	25	4	19	2	2	NPT 3/4"	ANSI B1.20.3	PSL2.2EDN.3	
	25	4	19	2	2	BSP 1"	DIN 3852-2-X	PSL2.2EEG.3	
	25	4	19	2	2	NPT 1"	ANSI B1.20.3	PSL2.2EEN.3	
IG 2	22	4A	16	2	2	3/4"-16 UNF 2B	SAE J 1926-1	PSL2.2DCU.3	
	22	4A	16	2	2	7/8"-14 UNF 2B	SAE J 1926-1	PSL2.2DGU.3	
	25	4	19	2	2	1"-1/16-12 UN 2B	SAE J 1926-1	PSL2.2EDU.3	
	25	4	19	2	2	1"-5/16-12 UN 2B	SAE J 1926-1	PSL2.2EEU.3	

THREADS

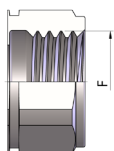

IG 1

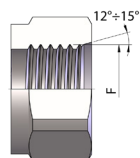

IG 2

FIXED PLATE PSL2

POS.	PART NUMBER	WEIGHT (g)
1	PSL.2C00.002	
2	PSQ.KIT.011	
3	PSQ.KIT.050	
4	PSL.KIT.043	
5	PSL.KIT.2902	
6	PSL.002.016	
7	SEE SPARE PARTS ISO16	
8	SEE SPARE PARTS ISO19	

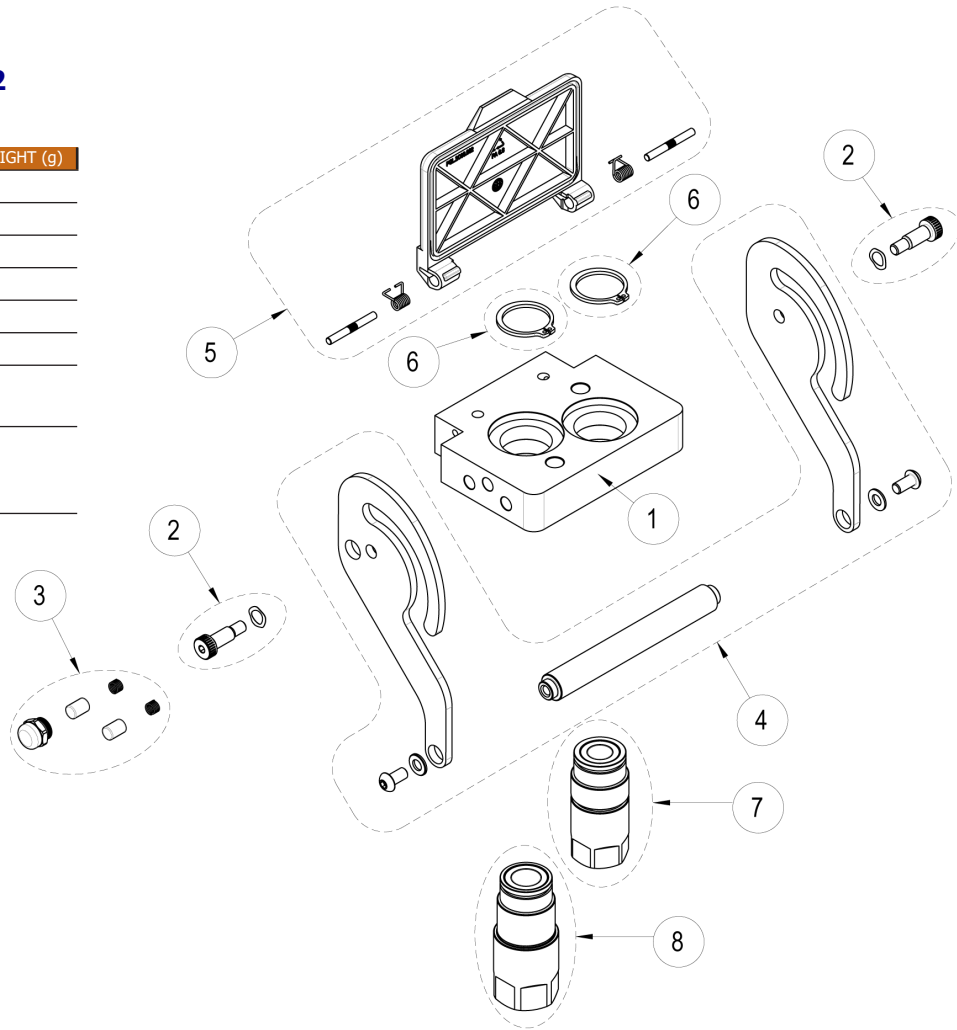

MOBILE PLATE PSL2

POS.	PART NUMBER	WEIGHT (g)
9	PSL.2C00.003	
10	PSQ.KIT.020	
11	PSL.KIT.017	
12	SEE SPARE PARTS ISO16	
13	SEE SPARE PARTS ISO19	

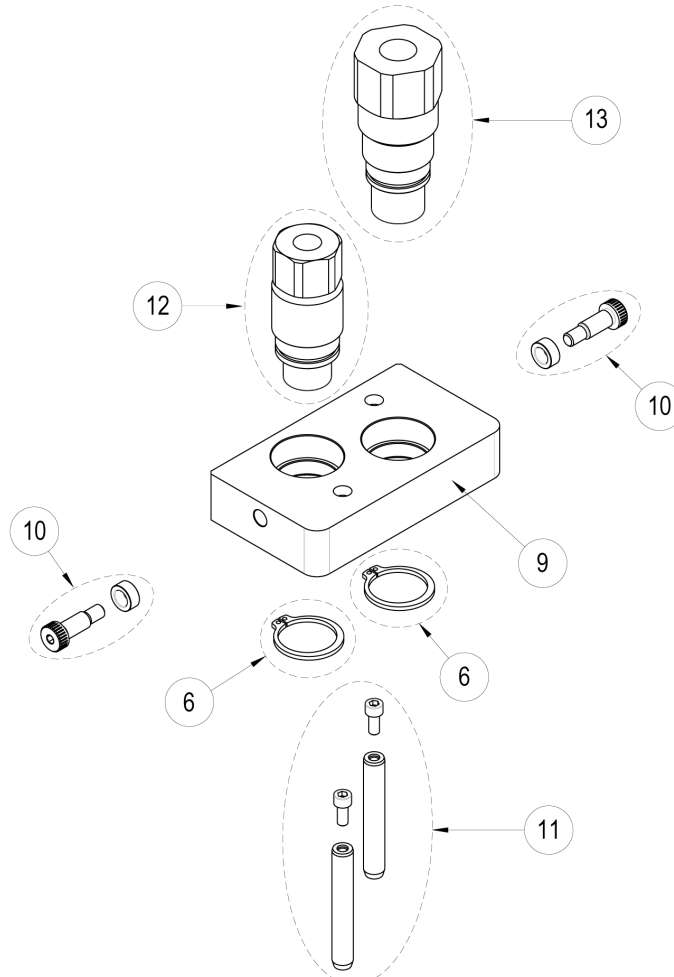

SPARE PARTS ISO 16 COUPLINGS

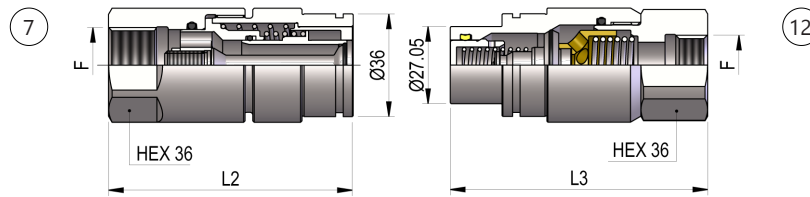

DNP	BG	ISO	L2	L3	L4	ØT	Thread F	STANDARD	SPARE PARTS CODE				
									FEMALE - MUFFE		MALE - STECKER		
22	4A	16							COD. F	Weight (g)	COD. M	Weight (g)	
IG 1			86	90.5			BSP 1/2"	DIN 3852-2-X	POT4.2213.112			POT4.2213.113	
			86	90.5			NPT 1/2"	ANSI B1.20.3	POT4.2213.012			POT4.2213.013	
			86	90.5			BSP 3/4"	DIN 3852-2-X	POT4.2219.112			POT4.2219.113	
			86	90.5			NPT 3/4"	ANSI B1.20.3	POT4.2219.012			POT4.2219.013	
IG 2			82	90.5			3/4"-16 UNF 2B	SAE J 1926-1	POT4.2219.032			POT4.2219.033	
			84	90.5			7/8"-14 UNF 2B	SAE J 1926-1	POT4.2223.032			POT4.2223.033	

SPARE PARTS ISO 19 COUPLINGS

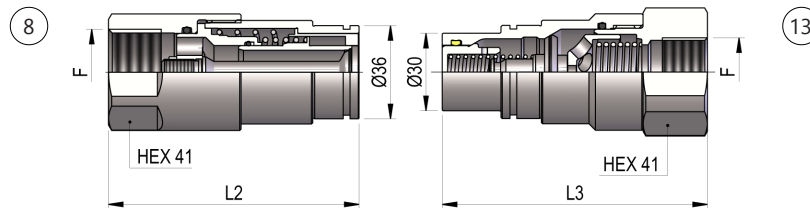

DNP	BG	ISO	L2	L3	L4	ØT	Thread F	STANDARD	SPARE PARTS CODE				
									FEMALE - MUFFE		MALE - STECKER		
25	4	19							COD. F	Weight (g)	COD. M	Weight (g)	
IG 1			94.5	103			BSP 3/4"	DIN 3852-2-X	POT4.2519.112			POT4.2519.113	
			94.5	104			NPT 3/4"	ANSI B1.20.3	POT4.2519.012			POT4.2519.013	
			97.5	107			BSP 1"	DIN 3852-2-X	POT4.2525.112			POT4.2525.113	
			97.5	107			NPT 1"	ANSI B1.20.3	POT4.2525.012			POT4.2525.013	
IG 2			95	104			1"1/16-12 UN 2B	SAE J 1926-1	POT4.2527.032			POT4.2527.033	
			95	105			1"5/16-12 UN 2B	SAE J 1926-1	POT4.2533.032			POT4.2533.033	

SPARE PARTS SEALS

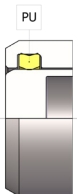

NOMINAL SIZE			MALE GASKET
DNP	BG	ISO	PU (POLYURETHANE)
16	4A	16	PVT.022.210
25	4	19	PVT.025.210

THREADS

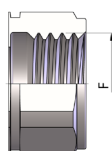

IG 1

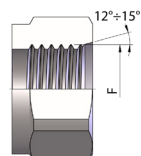

IG 2



Technical data

E

- Interchange:
- Occlusion: flat face
- Locking: lever with safety devices
- Material: steel and aluminum
- Finishing: Zn-Fe (Cr III), Zn-Ni, cataphoresis.
- Threads: BSP - NPT - SAE - METRIC
- Standard seals: NBR and PU
- Working temperature: -25 °C +100 °C
- Optional seals: FKM, EPDM or more
- Working pressure: 350 bar
- Connection under residual pressure: allowed (male side only)

Technische Merkmale

D

- Norm:
- Verschluss: flachdichtend
- Kupplung: Hebel mit doppelter Sicherung
- Werkstoff: Stahl und Aluminium
- Ausführung: Zn-Fe (Cr III), Zn-Ni, Kataphorese
- Gewinde: BSP – NPT – SAE – METRISCHE
- Standard-Dichtungen: NBR und PU
- Betriebstemperatur: -25 °C +100 °C
- Dichtungen nach Wahl: FKM, EPDM, usw.
- Betriebsdruck: 350 bar
- Kuppeln unter Restdruck: erlaubt (nur männliche Seite)

Nominal size				Max working pressure MPa	Rated flow l/min	Max flow rate l/min	Min burst pressure			Fluid spillage cc
DNP	BG	ISO	Ømm				Male MPa	Female MPa	Coupled MPa	
22	4A	16	12.8	35	74	150	140	140	140	0.012
25	4	19	14.8	35	100	200	140	140	140	0.015

1 MPa = 145.04 psi • 1 l = 0.264 gal

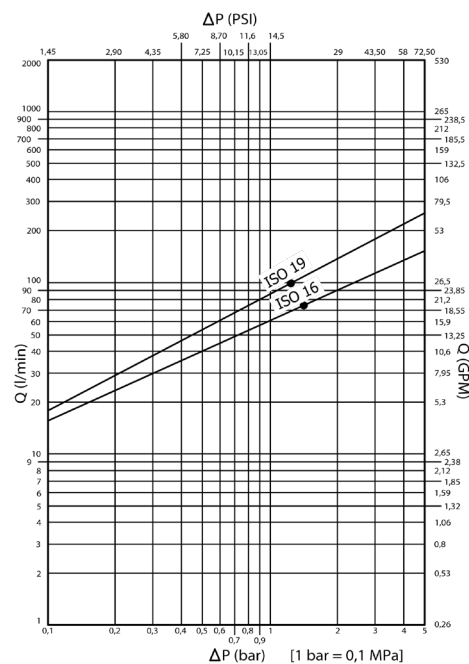

PSL4 DIMENSION

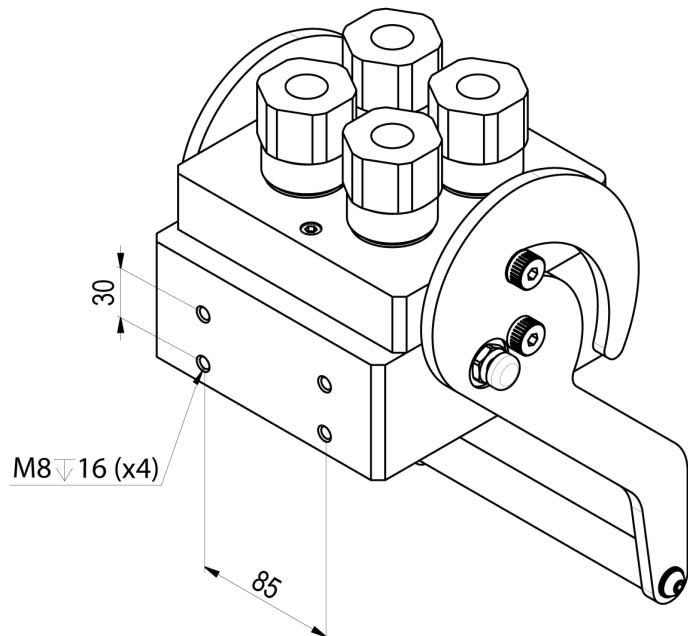
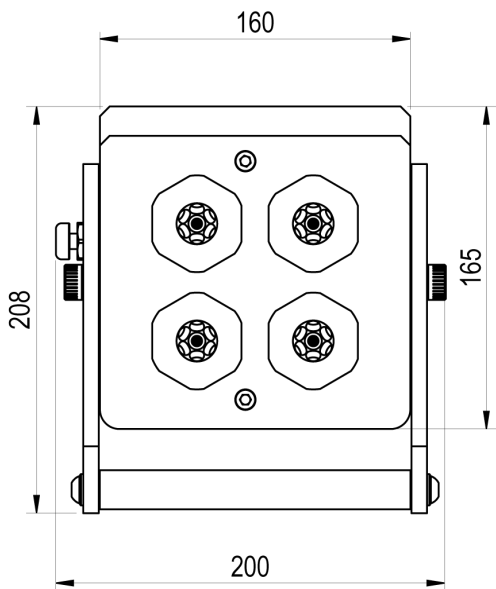
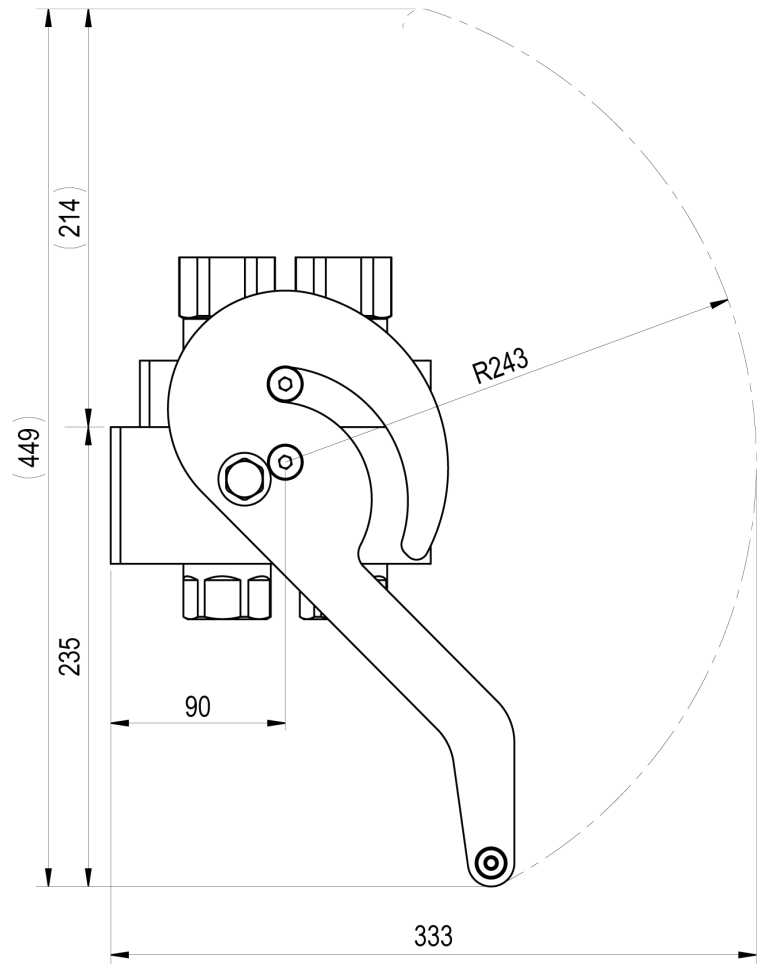
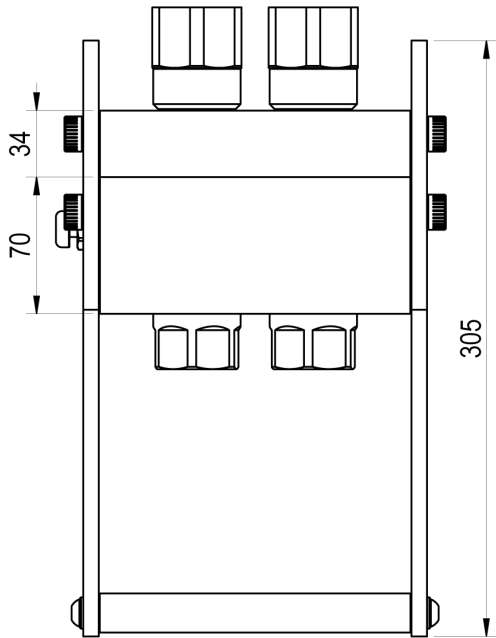

PSL4 FIXED



THREADS	DNP	BG	ISO	Housing	No. Couplings	Thread	STANDARD	FIXED PART CODE	
								CODE	Weight (g)
IG 1	22	4A	16	4	4	BSP 1/2"	DIN 3852-2-X	PSL4.4DCG.2	
	22	4A	16	4	4	NPT 1/2"	ANSI B1.20.3	PSL4.4DCN.2	
	22	4A	16	4	4	BSP 3/4"	DIN 3852-2-X	PSL4.4DDG.2	
	25	4	19	4	4	BSP 3/4"	DIN 3852-2-X	PSL4.4EDG.2	
	22	4A	16	4	4	NPT 3/4"	ANSI B1.20.3	PSL4.4DDN.2	
	25	4	19	4	4	NPT 3/4"	ANSI B1.20.3	PSL4.4EDN.2	
	25	4	19	4	4	BSP 1"	DIN 3852-2-X	PSL4.4EEG.2	
	25	4	19	4	4	NPT 1"	ANSI B1.20.3	PSL4.4EEN.2	
IG 2	22	4A	16	4	4	3/4"-16 UNF 2B	SAE J 1926-1	PSL4.4DCU.2	
	22	4A	16	4	4	7/8"-14 UNF 2B	SAE J 1926-1	PSL4.4DGU.2	
	25	4	19	4	4	1"-1/16-12 UN 2B	SAE J 1926-1	PSL4.4EDU.2	
	25	4	19	4	4	1"-5/16-12 UN 2B	SAE J 1926-1	PSL4.4EEU.2	

PSL4 MOBILE



THREADS	DNP	BG	ISO	Housing	No. Couplings	Thread	STANDARD	FIXED PART CODE	
								CODE	Weight (g)
IG 1	22	4A	16	4	4	BSP 1/2"	DIN 3852-2-X	PSL4.4DCG.3	
	22	4A	16	4	4	NPT 1/2"	ANSI B1.20.3	PSL4.4DCN.3	
	22	4A	16	4	4	BSP 3/4"	DIN 3852-2-X	PSL4.4DDG.3	
	25	4	19	4	4	BSP 3/4"	DIN 3852-2-X	PSL4.4EDG.3	
	22	4A	16	4	4	NPT 3/4"	ANSI B1.20.3	PSL4.4DDN.3	
	25	4	19	4	4	NPT 3/4"	ANSI B1.20.3	PSL4.4EDN.3	
	25	4	19	4	4	BSP 1"	DIN 3852-2-X	PSL4.4EEG.3	
	25	4	19	4	4	NPT 1"	ANSI B1.20.3	PSL4.4EEN.3	
IG 2	22	4A	16	4	4	3/4"-16 UNF 2B	SAE J 1926-1	PSL4.4DCU.3	
	22	4A	16	4	4	7/8"-14 UNF 2B	SAE J 1926-1	PSL4.4DGU.3	
	25	4	19	4	4	1"-1/16-12 UN 2B	SAE J 1926-1	PSL4.4EDU.3	
	25	4	19	4	4	1"-5/16-12 UN 2B	SAE J 1926-1	PSL4.4EEU.3	

THREADS

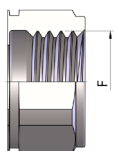

IG 1

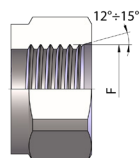

IG 2

FIXED PLATE PSL4

POS.	PART NUMBER	WEIGHT (g)
1	PSL.4C00.102	
2	PSQ.KIT.011	
3	PSQ.KIT.050	
4	PSL.KIT.041	
5	PSL.002.016	
6	SEE SPARE PARTS ISO16	
7	SEE SPARE PARTS ISO19	

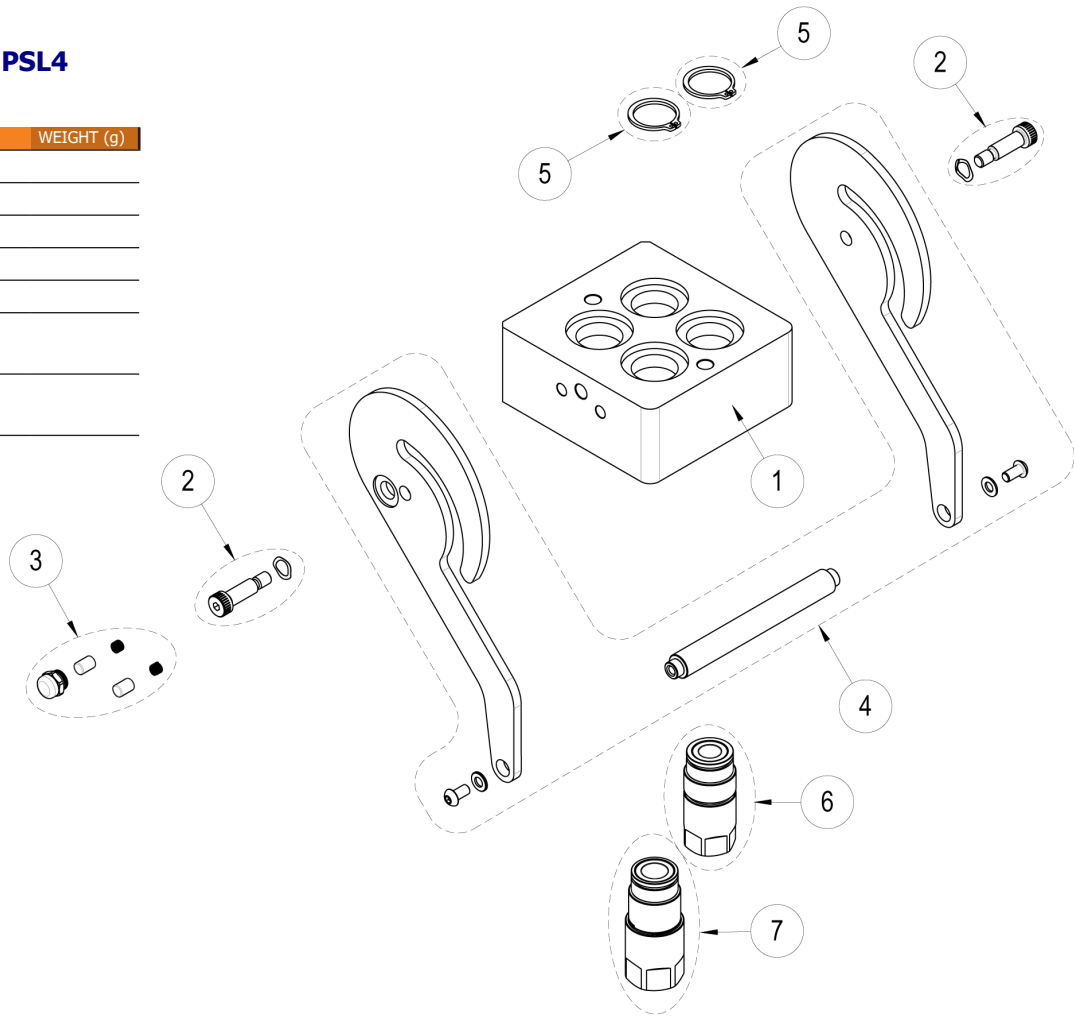

MOBILE PLATE PSL4

POS.	PART NUMBER	WEIGHT (g)
8	PSL.4C00.103	
9	PSL.KIT.020	
10	PSL.KIT.017	
11	SEE SPARE PARTS ISO16	
12	SEE SPARE PARTS ISO19	

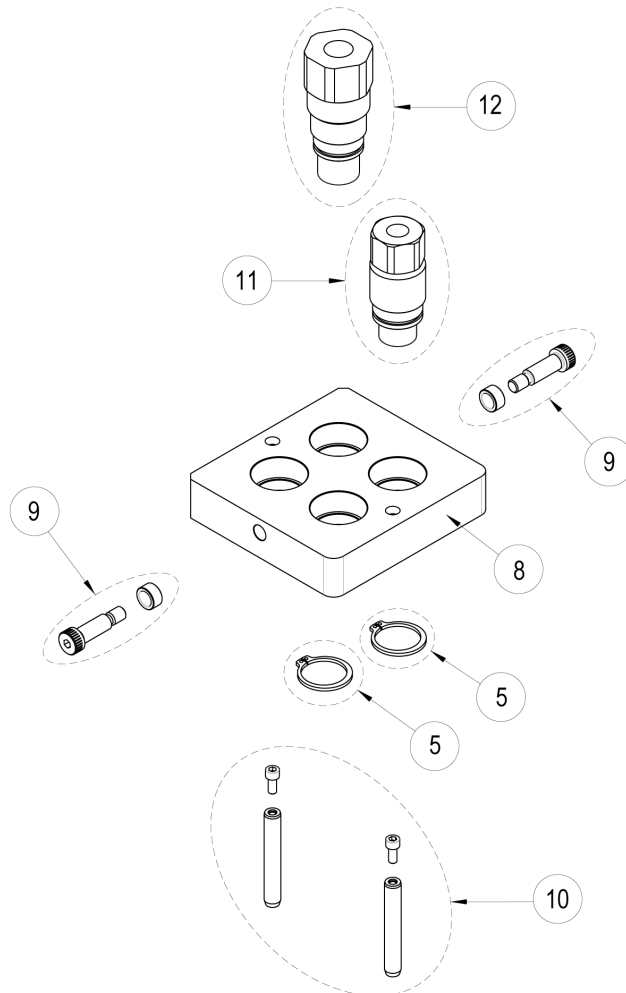

SPARE PARTS ISO 16 COUPLINGS

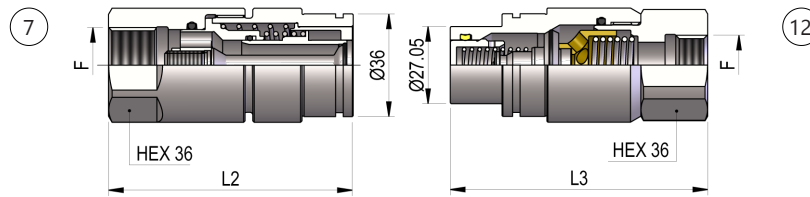

DNP	BG	ISO	L2	L3	L4	ØT	Thread F	STANDARD	SPARE PARTS CODE				
									FEMALE - MUFFE		MALE - STECKER		
22	4A	16							COD. F	Weight (g)	COD. M	Weight (g)	
IG 1			86	90.5			BSP 1/2"	DIN 3852-2-X	POT4.2213.112			POT4.2213.113	
			86	90.5			NPT 1/2"	ANSI B1.20.3	POT4.2213.012			POT4.2213.013	
			86	90.5			BSP 3/4"	DIN 3852-2-X	POT4.2219.112			POT4.2219.113	
			86	90.5			NPT 3/4"	ANSI B1.20.3	POT4.2219.012			POT4.2219.013	
IG 2			82	90.5			3/4"-16 UNF 2B	SAE J 1926-1	POT4.2219.032			POT4.2219.033	
			84	90.5			7/8"-14 UNF 2B	SAE J 1926-1	POT4.2223.032			POT4.2223.033	

SPARE PARTS ISO 19 COUPLINGS

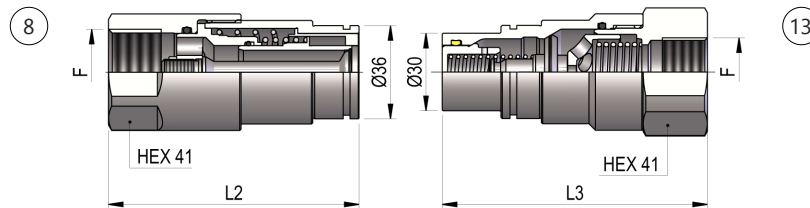

DNP	BG	ISO	L2	L3	L4	ØT	Thread F	STANDARD	SPARE PARTS CODE				
									FEMALE - MUFFE		MALE - STECKER		
25	4	19							COD. F	Weight (g)	COD. M	Weight (g)	
IG 1			94.5	103			BSP 3/4"	DIN 3852-2-X	POT4.2519.112			POT4.2519.113	
			94.5	104			NPT 3/4"	ANSI B1.20.3	POT4.2519.012			POT4.2519.013	
			97.5	107			BSP 1"	DIN 3852-2-X	POT4.2525.112			POT4.2525.113	
			97.5	107			NPT 1"	ANSI B1.20.3	POT4.2525.012			POT4.2525.013	
IG 2			95	104			1"1/16-12 UN 2B	SAE J 1926-1	POT4.2527.032			POT4.2527.033	
			95	105			1"5/16-12 UN 2B	SAE J 1926-1	POT4.2533.032			POT4.2533.033	

SPARE PARTS SEALS

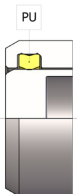

NOMINAL SIZE			MALE GASKET
DNP	BG	ISO	PU (POLYURETHANE)
16	4A	16	PVT.022.210
25	4	19	PVT.025.210

THREADS

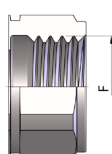

IG 1

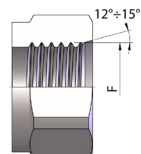

IG 2



Technical data

E

- Interchange:
- Occlusion: flat face
- Locking: lever with safety devices
- Material: steel and aluminum
- Finishing: Zn-Fe (Cr III), Zn-Ni, cataphoresis.
- Threads: BSP - NPT - SAE - METRIC
- Standard seals: NBR and PU
- Working temperature: -25 °C +100 °C
- Optional seals: FKM, EPDM or more.
- Working pressure: 350 bar
- Connection under residual pressure: allowed (male side only)

Technische Merkmale

D

- Norm:
- Verschluss: flachdichtend
- Kupplung: Hebel mit doppelter Sicherung
- Werkstoff: Stahl und Aluminium
- Ausführung: Zn-Fe (Cr III), Zn-Ni, Kataphorese.
- Gewinde: BSP – NPT – SAE – METRISCHE
- Standard-Dichtungen: NBR und PU
- Betriebstemperatur: -25 °C +100 °C
- Dichtungen nach Wahl: FKM, EPDM, usw.
- Betriebsdruck: 350 bar
- Kuppeln unter Restdruck: erlaubt (nur männliche Seite)

Nominal size				Max working pressure MPa	Rated flow l/min	Max flow rate l/min	Min burst pressure			Fluid spillage cc
DNP	BG	ISO	Ømm				Male MPa	Female MPa	Coupled MPa	
22	4A	16	12.8	35	74	150	140	140	140	0.012
25	4	19	14.8	35	100	200	140	140	140	0.015

1 MPa = 145.04 psi • 1 l = 0.264 gal

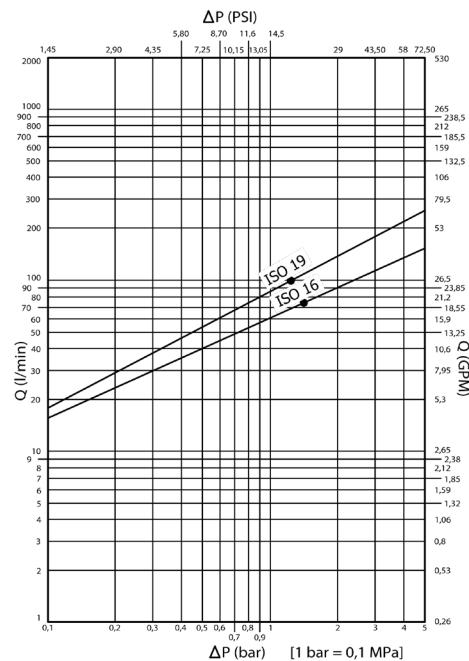

PSL6 DIMENSION

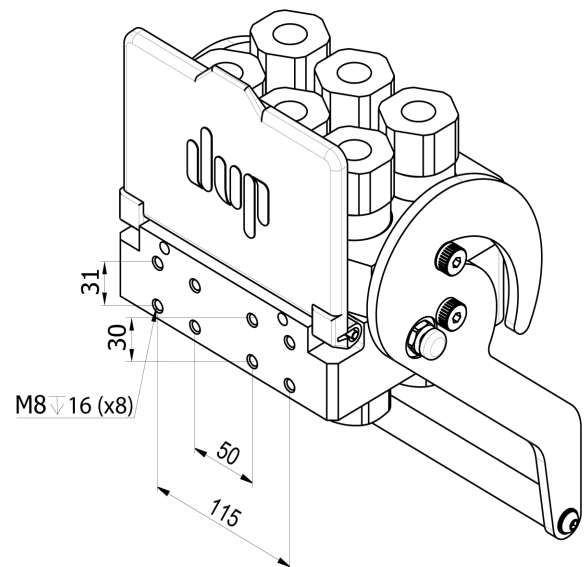
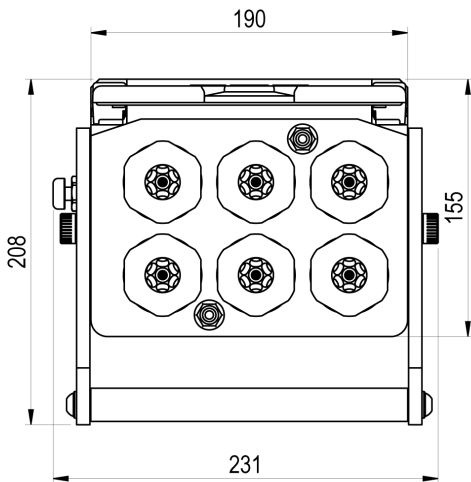
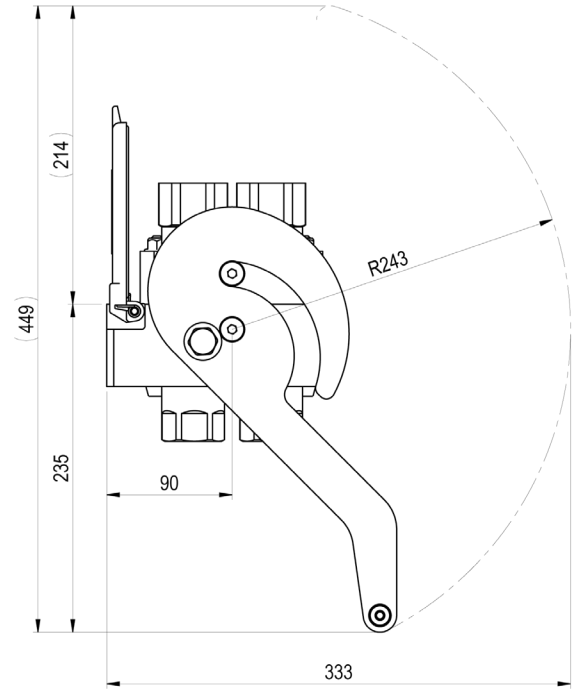
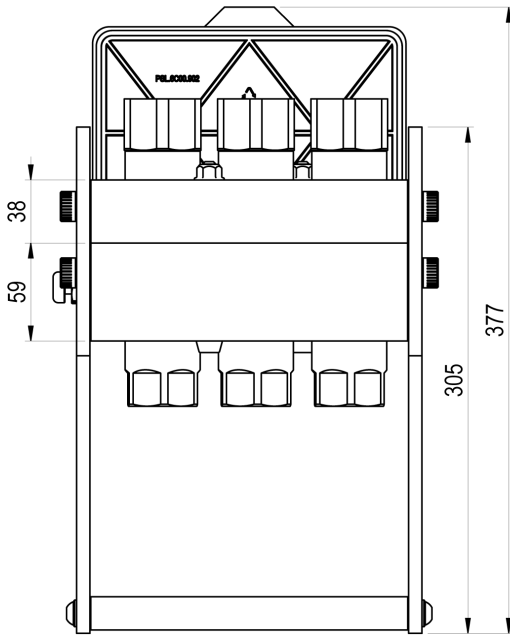

PSL6 FIXED



THREADS	DNP	BG	ISO	Housing	No. Couplings	Thread	STANDARD	FIXED PART CODE	
								CODE	Weight (g)
IG 1	22	4A	16	6	6	BSP 1/2"	DIN 3852-2-X	PSL6.6DCG.2	
	22	4A	16	6	6	NPT 1/2"	ANSI B1.20.3	PSL6.6DCN.2	
	22	4A	16	6	6	BSP 3/4"	DIN 3852-2-X	PSL6.6DDG.2	
	25	4	19	6	6	BSP 3/4"	DIN 3852-2-X	PSL6.6EDG.2	
	22	4A	16	6	6	NPT 3/4"	ANSI B1.20.3	PSL6.6DDN.2	
	25	4	19	6	6	NPT 3/4"	ANSI B1.20.3	PSL6.6EDN.2	
	25	4	19	6	6	BSP 1"	DIN 3852-2-X	PSL6.6EEG.2	
	25	4	19	6	6	NPT 1"	ANSI B1.20.3	PSL6.6EEN.2	
IG 2	22	4A	16	6	6	3/4"-16 UNF 2B	SAE J 1926-1	PSL6.6DCU.2	
	22	4A	16	6	6	7/8"-14 UNF 2B	SAE J 1926-1	PSL6.6DGU.2	
	25	4	19	6	6	1"-1/16-12 UN 2B	SAE J 1926-1	PSL6.6EDU.2	
	25	4	19	6	6	1"-5/16-12 UN 2B	SAE J 1926-1	PSL6.6EEU.2	

PSL6 MOBILE



THREADS	DNP	BG	ISO	Housing	No. Couplings	Thread	STANDARD	FIXED PART CODE	
								CODE	Weight (g)
IG 1	22	4A	16	6	6	BSP 1/2"	DIN 3852-2-X	PSL6.6DCG.3	
	22	4A	16	6	6	NPT 1/2"	ANSI B1.20.3	PSL6.6DCN.3	
	22	4A	16	6	6	BSP 3/4"	DIN 3852-2-X	PSL6.6DDG.3	
	25	4	19	6	6	BSP 3/4"	DIN 3852-2-X	PSL6.6EDG.3	
	22	4A	16	6	6	NPT 3/4"	ANSI B1.20.3	PSL6.6DDN.3	
	25	4	19	6	6	NPT 3/4"	ANSI B1.20.3	PSL6.6EDN.3	
	25	4	19	6	6	BSP 1"	DIN 3852-2-X	PSL6.6EEG.3	
	25	4	19	6	6	NPT 1"	ANSI B1.20.3	PSL6.6EEN.3	
IG 2	22	4A	16	6	6	3/4"-16 UNF 2B	SAE J 1926-1	PSL6.6DCU.3	
	22	4A	16	6	6	7/8"-14 UNF 2B	SAE J 1926-1	PSL6.6DGU.3	
	25	4	19	6	6	1"-1/16-12 UN 2B	SAE J 1926-1	PSL6.6EDU.3	
	25	4	19	6	6	1"-5/16-12 UN 2B	SAE J 1926-1	PSL6.6EEU.3	

THREADS

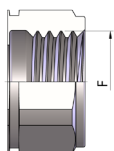

IG 1

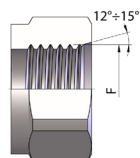

IG 2

FIXED PLATE PSL6

POS.	PART NUMBER	WEIGHT (g)
1	PSL.6C00.002	
2	PSQ.KIT.011	
3	PSQ.KIT.050	
4	PSL.KIT.042	
5	PSL.KIT.6902	
6	PSL.002.016	
7	SEE SPARE PARTS ISO16	
8	SEE SPARE PARTS ISO19	

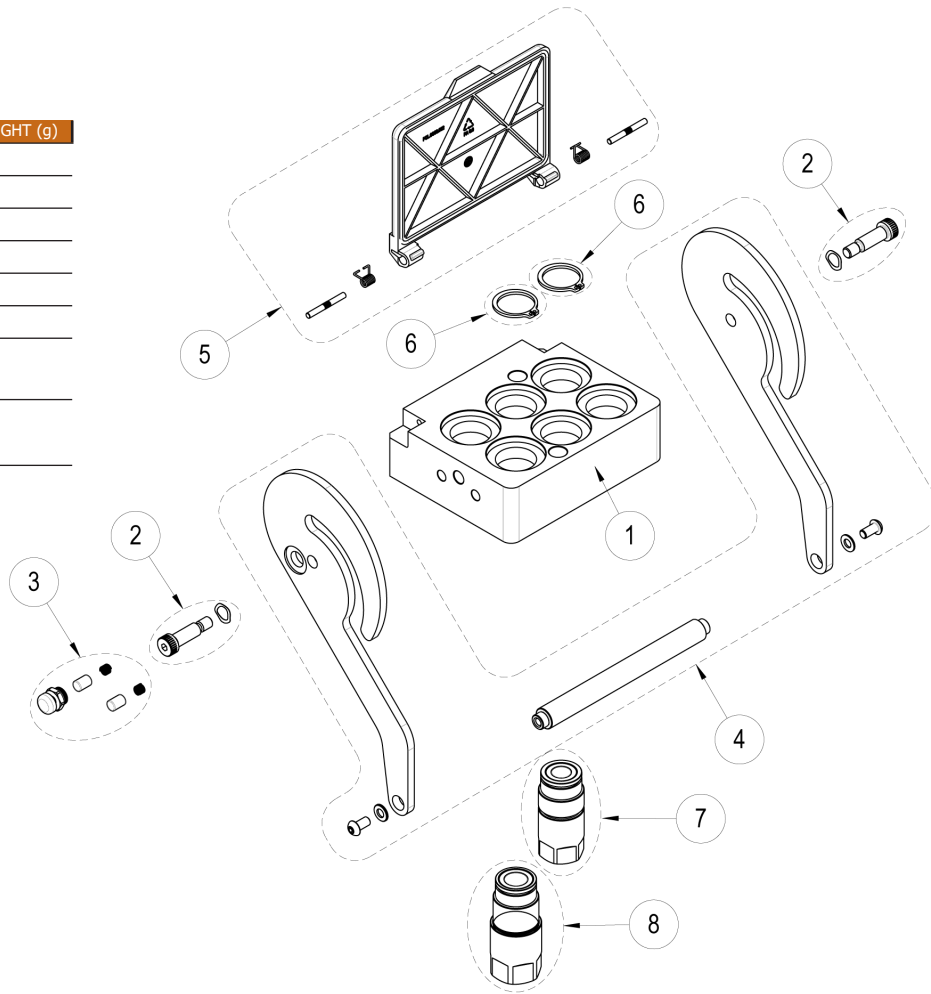

MOBILE PLATE PSL6

POS.	PART NUMBER	WEIGHT (g)
9	PSL.6C00.003	
10	PSL.KIT.020	
11	PSL.KIT.117	
12	SEE SPARE PARTS ISO16	
13	SEE SPARE PARTS ISO19	

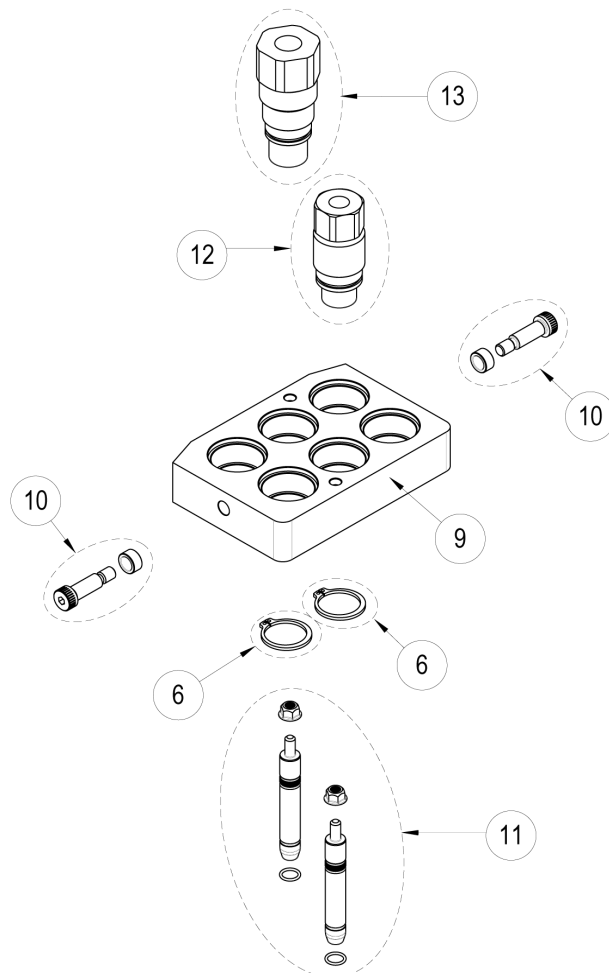

SPARE PARTS ISO 16 COUPLINGS

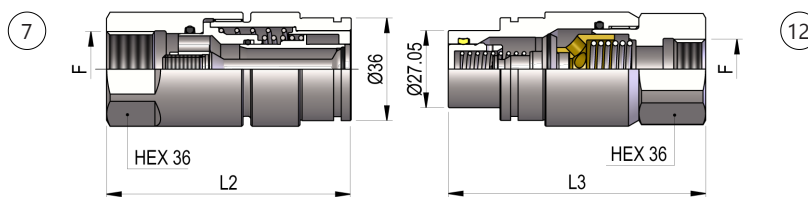

DNP	BG	ISO	L2	L3	L4	ØT	Thread F	STANDARD	SPARE PARTS CODE				
									FEMALE - MUFFE		MALE - STECKER		
22	4A	16							COD. F	Weight (g)	COD. M	Weight (g)	
IG 1			86	90.5			BSP 1/2"	DIN 3852-2-X	POT4.2213.112		POT4.2213.113		
			86	90.5			NPT 1/2"	ANSI B1.20.3	POT4.2213.012		POT4.2213.013		
			86	90.5			BSP 3/4"	DIN 3852-2-X	POT4.2219.112		POT4.2219.113		
			86	90.5			NPT 3/4"	ANSI B1.20.3	POT4.2219.012		POT4.2219.013		
IG 2			82	90.5			3/4"-16 UNF 2B	SAE J 1926-1	POT4.2219.032		POT4.2219.033		
			84	90.5			7/8"-14 UNF 2B	SAE J 1926-1	POT4.2223.032		POT4.2223.033		

SPARE PARTS ISO 19 COUPLINGS

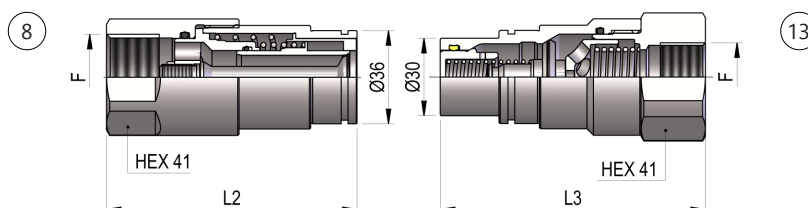

DNP	BG	ISO	L2	L3	L4	ØT	Thread F	STANDARD	SPARE PARTS CODE				
									FEMALE - MUFFE		MALE - STECKER		
25	4	19							COD. F	Weight (g)	COD. M	Weight (g)	
IG 1			94.5	103			BSP 3/4"	DIN 3852-2-X	POT4.2519.112		POT4.2519.113		
			94.5	104			NPT 3/4"	ANSI B1.20.3	POT4.2519.012		POT4.2519.013		
			97.5	107			BSP 1"	DIN 3852-2-X	POT4.2525.112		POT4.2525.113		
			97.5	107			NPT 1"	ANSI B1.20.3	POT4.2525.012		POT4.2525.013		
IG 2			95	104			1"1/16-12 UN 2B	SAE J 1926-1	POT4.2527.032		POT4.2527.033		
			95	105			1"5/16-12 UN 2B	SAE J 1926-1	POT4.2533.032		POT4.2533.033		

SPARE PARTS SEALS

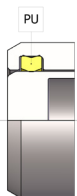

NOMINAL SIZE			MALE GASKET
DNP	BG	ISO	PU (POLYURETHANE)
16	4A	16	PVT.022.210
25	4	19	PVT.025.210

THREADS

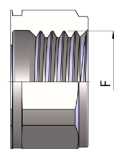

IG 1

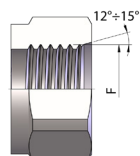

IG 2